

Power Line Chokes Drum Core Style

Designed for Noise, Spike & Filtering applications.

Electrical Specifications at 25°C

Part Number	L ⁽¹⁾ ± 10% (μ H)	DCR Nom. (m Ω)	I ⁽²⁾ Max. (A)	Size Code
L-61400	15	10.2	6.0	D
L-61401	50	30.4	4.0	D
L-61402	100	57.8	3.2	D
L-61403	150	100	2.5	D
L-61404	200	122	2.0	D
L-61405	350	172	2.0	D
L-61406	450	237	1.6	D
L-61407	600	339	1.2	D
L-61408	750	476	1.0	D

1. Tested at 1 kHz & 100 mV
2. DC Current at 250 circular mills per Amp.

Applications

Power Supplies
Filters
SCR and Triac Controls
OEM Equipment
Telephones
TV, CRT'S, VCR'S
Appliances

Self Leads

Leads tinned to within 1/16" of body.

Coils finished with UL rated varnish.

Variations on electrical parameters of parts listed are available - Please contact factory.

Schematic Diagram

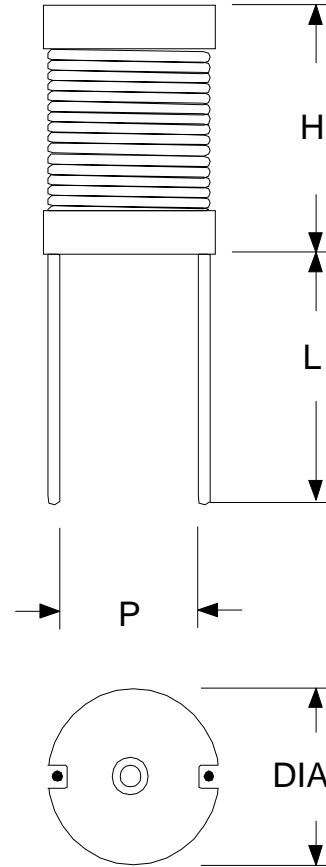
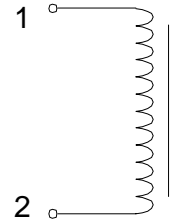

Reference Dimensions in Inches (mm)			
H	DIA.	P	L
.59 (15.0)	.49 (12.4)	.40 (10.1)	.75 (19.0)