

100BASE-T INTERFACE TRANSFORMER

Reinforced Insulation Per EN 41003/EN 60950

Turns Ratio ($\pm 5\%$)	1CT:1CT
---------------------------	---------

Meets IEE 802.3 and ANSI X3.263 Standards.

Parameter	Min.	Max.	Units
Open Circuit Inductance (8mA DC Bias)	350		μH
Leakage Inductance		0.9	μH
Interwinding Capacitance (C_{WW})		10	pF
Primary DC Resistance		0.9	ohms
Secondary DC Resistance		1.0	ohms
Insertion Loss (0.1 - 100MHz)		-1.0	dB
Return Loss			
1 - 30 MHz	-22		dB
40 MHz	-20		dB
50 MHz	-18		dB
60 - 80 MHz	-12		dB
Isolation (HI-POT)	4000		V_{RMS}

Transformer can be used for Transmit or Receive side.

Flammability: Materials used in the production of these units meet requirements of UL94-VO and IEC 695-2-2 needle flame test.

Parts shipped in anti-static tubes.
31 pieces per tube

Surface mount version of this part available. Part# T-1477G

OPERATING TEMPERATURE RANGE:
-40°C TO +85°C

Physical Dimensions
inches (mm)

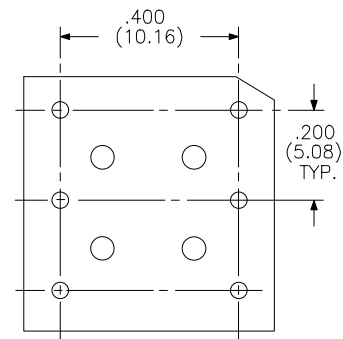
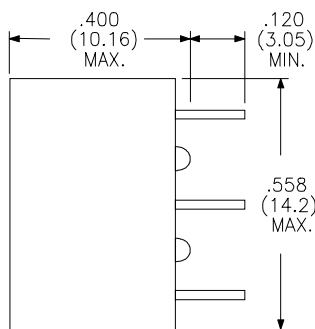
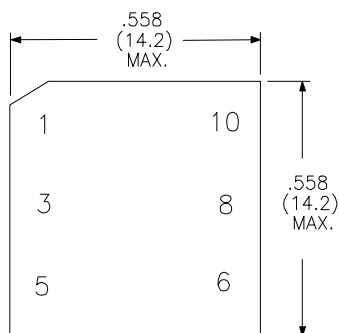

Schematic Diagram

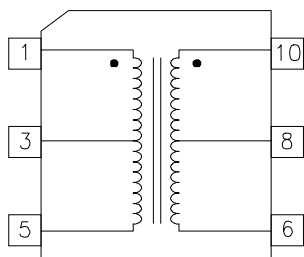

PRELIMINARY!

RHOMBUS P/N: T-1477	
CUST P/N:	NAME:
DATE: 12/14/01	SHEET: 1 OF 1