

# POWER LINE CHOKE

## (DRUM CORE STYLE)

Electrical Specifications at 25°C

Parameter	Min.	Typ.	Max.	Units
Inductance	160	200	240	μH
I <sub>MAX</sub>		19.2		A
DCR		.019		Ω
Lead Diameter		.0808 (2.05)		inches (mm)

### Applications

Power Amplifiers  
 Filters Power Supplies  
 SCR and Triac Controls  
 Speaker Crossover Networks  
 RFI Suppression

### Test Conditions:

Inductance tested at 100 mV<sub>RMS</sub> and 1 kHz

1. Current for 10% drop in Inductance

PHYSICAL DIMENSIONS All dimensions in inches

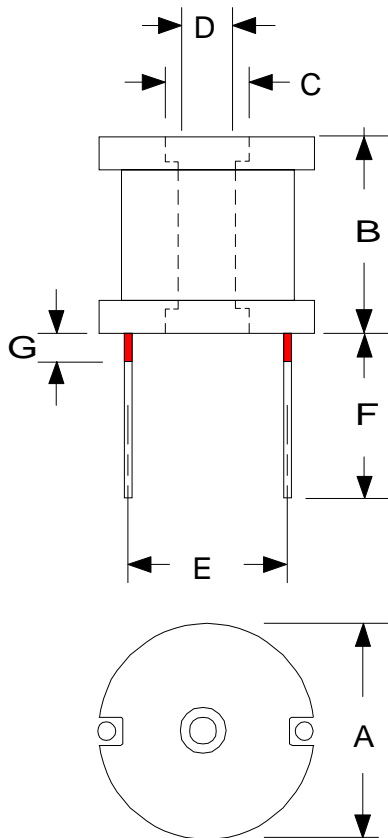

Dim.	inches
A	1.810
B	1.400
C	0.350
D	0.270
E	1.500
F	0.750
G	0.062

High Saturation  
 Pre-Tinned Leads  
 Center hole for mechanical mounting

Leads are .025 (# 11 AWG)  
 Leads tinned to within 1/16" of body.

RHOMBUS P/N: <b>L-12590</b>	
CUST P/N:	NAME:
DATE: <b>08/17/01</b>	SHEET: 1 OF 1