

POWER LINE CHOKE

(DRUM CORE STYLE)

Electrical Specifications at 25°C

Parameter	Min.	Typ.	Max.	Units
Inductance		300		μH
I_{MAX}^1			8.0	A
DCR		85		mΩ
Lead Diameter		.0359 (0.912)		inches (mm)

Applications

Power Amplifiers
 Filters Power Supplies
 SCR and Triac Controls
 Speaker Crossover Networks
 RFI Suppression

Test Conditions:

Inductance tested at 100 mV_{RMS} and 1 kHz

All dimensions in inches

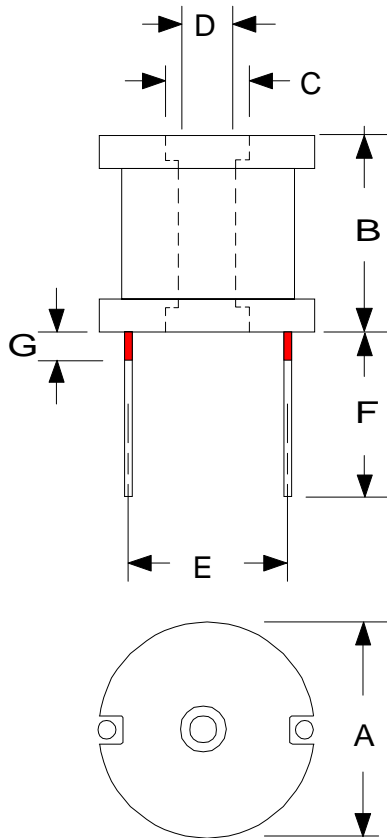

Dim.	inches
A	0.949
B	0.795
C	0.187
D	0.126
E	0.750
G	0.062

High Saturation
 Pre-Tinned Leads
 Center hole for mechanical mounting

Leads are .0359 (#19 AWG)
 Leads tinned to within 1/16" of body.

RHOMBUS P/N: L-12478	
CUST P/N:	NAME:
DATE: 04/28/00	SHEET: 1 OF 1