

POWER LINE CHOKE

(DRUM CORE STYLE)

Electrical Specifications at 25°C

Parameter	Min.	Typ.	Max.	Units
Inductance	24	30	36	μH
I_{MAX}^1			5.2	A
DCR		21		mΩ
Lead Diameter		.036 (0.914)		inches (mm)

Applications

Power Amplifiers

Filters Power Supplies

SCR and Triac Controls

Speaker Crossover Networks

RFI Suppression

Test Conditions:

Inductance tested at 100 mV_{RMS} and 1 kHz

1. Current for 10% drop in Inductance

PHYSICAL DIMENSIONS

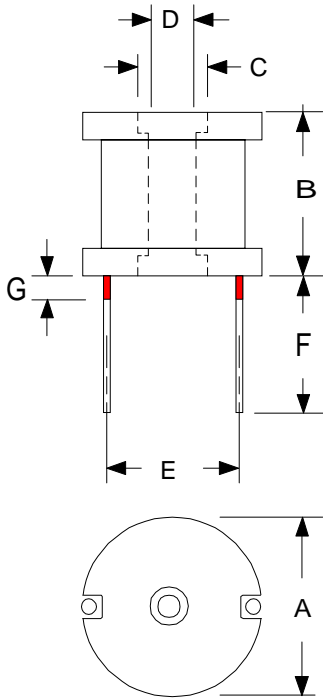

Dim.	inches
A	0.560
B	0.810
C	0.187
D	0.126
E	0.500
F	0.750
G	0.062

High Saturation

Pre-Tinned Leads

Center hole for mechanical mounting

Leads are .036 (#19 AWG)

RHOMBUS P/N: **L-12206**

CUST P/N:

NAME:

DATE: **01/10/02**

SHEET: 1 OF 1